



Light through colourful glass, Photo is courtesy of <https://www.pinterest.com.au/>

The Illuminating Engineering Society of Australia and New Zealand is an organization with Chapters in the five mainland States of Australia and New Zealand. The Society operates under the name: IES: The Lighting Society.

The aim of the Society is the advancement of the art and science of illumination and the dissemination of knowledge to all interested parties. The Society's diversified membership includes engineers, architects, educators, students, contractors, manufacturers and designers.

Arcus

Arcus is the official newsletter of the QLD Chapter of the Illuminating Engineering Society of Australia and New Zealand.

Memberships

There are two types of membership available; individual and corporate (or company).

For further information on membership contact Queensland Chapter at the below address or visit the ies website.

QLD Chapter Management Committee

- President:** Andrew Chase
- Vice President/ Lighting Design Awards:** Steve Hare
- Annual Dinner:** Andrew Chase
- Secretary & Treasurer:** Michelle Knowles
- Membership and Education:** Quang Tran
- Arcus:** Majdi Hawari
- Luminaire Design Awards:** Eric Isdale
- Student Liaison/Educators Committee:** Gillian Isoardi
- Technical Meetings:** Peter Parnell
- Advocacy:** Paul Doig, Trent Dutton & Doug Brimblecombe

Advertising

To advertise into Arcus please contact the QLD Chapter Secretary at the email address provided on this page.

Pricing for advertising is \$20 for members and \$50 for non-members.

Member Page

IES Qld Chapter members are welcome to submit information on employment changes – including new positions, promotions, and ‘available for hire’, for inclusion in Arcus. Members wishing to be included are requested to send a photo and a short blurb (20 – 30 words) for inclusion in the newsletter, to the editor, **Majdi Hawari**, at mhawari@hotmail.com.au

NOVEMBER 2018

TABLE OF CONTENTS

PRESIDENT’S MESSAGE 3

QUEENSLAND LIGHTING DESIGN AWARDS ENTRANTS 4

QUEENSLAND LUMINAIRE DESIGN AWARDS ENTRANTS 10

NEW MEMBERS ANNOUNCEMENT 11

EDUCATION 11

2018 QLD PRESENTATION AND ANNUAL DINNER.....12

TOUCH THE FLICKER ADVERTISEMENT.....14

BENEFIT TO MEMBERS (INSURANCE)..... 15

CURRENT CORPORATE MEMBERS..... 16

[Visit the Lighting Society at \(click on icon\)](#)



The Illuminating Engineering Society
Queensland Chapter
Level 2,70 Merivale Street
P.O. Box 3275
SOUTH BRISBANE QLD 4101
Phone:02 9431 8663
Email: qldsecretary@iesanz.org
Website: www.iesanz.org

PRESIDENT'S MESSAGE

Welcome everyone to this month's instalment of Arcus!

With the industry night of nights looming large on Friday 23rd of November at Cloudland in Fortitude Valley, we still have a couple of full-tables available so please take the opportunity and book a seat at the table.

As mentioned in my last message, MC on the night will be Dr Karl Kruszelnicki and I for one am looking forward to hearing Dr Karl's thoughts on lighting in general and how he views our industry.

I am also looking forward to catching up with those that I know and hopefully meet some of you I am yet to meet.

During the month of October, the IES embarked on a new way of conducting the Technical Meetings. On October 25th we conducted a Webinar style Technical Meeting during the day to which we had 30 attendees at the venue and 90 people online. This was an outstanding result so many thanks to Trent Dutton and Peter Parnell for organizing this event. This will not take the place of the other Technical Talks and Peter Parnell will be organising these during 2019.

If you haven't booked already, please come along to a fun night and a time where we get to honour all of the awards entries as well as the Award Winners.

Finally, thanks to the Platinum Sponsors iGuzzini and Gold Sponsors Darkon, GM Poles, Eagle Lighting, Advanced Lighting and Versalux who without their support the night would not be possible.

As always, please don't forget about our social media platforms:



Thank you,

Andrew Chase
Queensland Chapter President
qldsecretary@iesanz.org

QUEENSLAND LIGHTING DESIGN AWARDS ENTRANTS

The Springfield Anglican College Resource Centre

Designers: *Toby Murdoch & Janak Gamage – Ashburner Francis*

Ashburner Francis and Fulton worked closely to form a coherent lighting design to compliment architectural form. The lighting design objectives were to enhance the volume of the space by taking full advantage of the high sloping ceilings, and to highlight the premium interior finishes throughout by providing high quality lighting. A key feature of the design is the organically shaped, custom designed curvilinear light fitting above the central seating area, which is intended to informally delineate the area and to continue the relaxed feel of this casual space through the fluid shape.

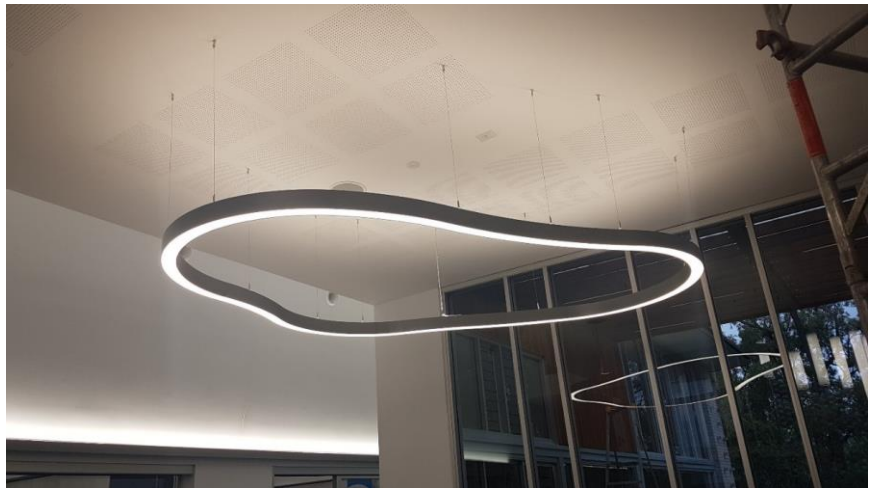

Toowoomba City Hall Auditorium and Annex

Designers: *Lester Walters & Brian Kenny – Ashburner Francis*

The Auditorium and Annex spaces adjoin the historic City Hall Building. Originally built in 1900, the heritage listed Auditorium has been restored to its 1937 Art Deco fit-out. The new lighting to auditorium has faithfully reinstated the 1930's installation, with custom made art-deco steel framed lights, and cove lighting concealed within the restored moulded ceiling. The Annex space is a new extension to the Auditorium, with contemporary architecture and lighting, and an illuminated façade facing into the Civic Square.



Walter's Steakhouse - Brisbane

Designer: *Carl Gray – Graylight*

Walter's Steakhouse is a premium restaurant fashioned after the steakhouses of early 20th century New York. Located in the heritage Old Mineral House opposite Brisbane City Botanic Gardens, the bar and restaurant are meticulously styled to the period; wit dark timber, leather, brass, reeded glass, and golden-warm lighting throughout.

Between the lighting, interior design, old-fashioned service, and impeccable food; you will be forgiven for thinking you're in old New York.



Sturdee Park Upgrade – Loganlea

Designers: *Property Technologies and Gerard Lighting*

Motion sensed lighting of a pathway using LED lighting.



Cherry- Gold Coast

Designers: *Point of View – TDL*

The brief to the team was to deliver a bar that had a unique and sophisticated ambience that offered guests an exciting place to meet in the heart of the action at the newly emerging Broadbeach property. The new bar was to be stylish, alluring, 'private' and privileged. The slightly elevated platform from the surrounding areas and circulation zones immediately gave it this exclusive presence.

As the interior design went through the inevitable concept/design and development shuffle, what was emerging was symmetry.

The bar's entrance is on a visual entry axis directly adjacent to the Main Gaming Floor's entry point off from the property's Atrium area.

As one approaches the bar, two privates 'bird cage' booths stand sentinel to the wide-stepped entry, and on either side, gently inclined ramps offer an alternative entrance and ensure it is accessible for all.

The bar wall is the strong visual element of Cherry. The service bar is 22m long.

A Dali/Dynalite lighting control system sits remotely, as probably the most vital component of the design, to allow us to direct the accurate quantity and mix of light to the chosen parts of the room. Several pre-set scenes were created to allow for initial operations which will be tweaked as time goes by.

All light sources are LED at a chosen colour temperature of 3000K.



Kurrawa Surf Club - Broadbeach

Designer: *Ash Dowthwaite*

Kurrawa Surf Life Saving Club was formed in September 1958 and has a rich and rewarding history in both lifesaving and surf sports. Kurrawa is in the heart of Broadbeach, Queensland and sees over 5,000 frequent Kurrawa Beach daily.

We were approached by Paynter & Dixon, a specialist design & construct company to be part of a team to design a new building on the existing site, the design architects being Arkhefield – Brisbane.

The building is a two-storey structure, the Ground Level comprising the main reception/entrance to the north & much of the remaining ground level areas are related to the operation of the surf lifesaving aspects of the club, stores, clubroom amenities etc.

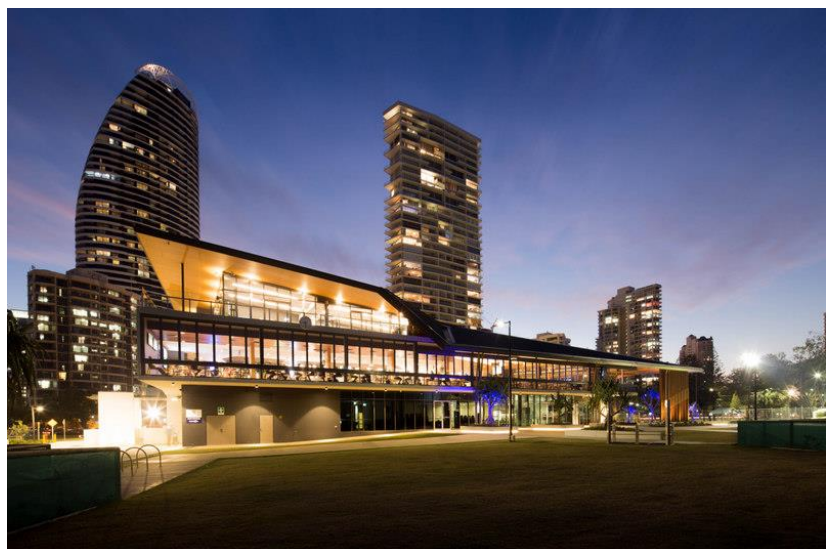

The focus of our involvement was the FOH areas embracing an upper level bar, related lounge areas, a gaming room and the all-important, infamous, bistro. We also participated in the illumination of the external bits of the building including landscape.

Pullman Airport Hotel - Brisbane Airport

Designers: *Point of View – TDLD*

The recently completed Pullman Hotel at Brisbane Airport is the 5 Star wing of the broader Ibis + Pullman offering for the travellers to the Queensland hub.

The site, adjacent to the Domestic Terminal was developed by the Flynn (family) Property Group, who has other interests in the Brisbane Airports precinct. The entire development comprises the Ibis 3 Star Hotel, the Pullman 5 Star Hotel & a Conference & Convention Centre that separates the two.

The focus of this submission is the Pullman Hotel Entrance Lobby & associated FOH areas, Lobby Bar, Restaurant zone.

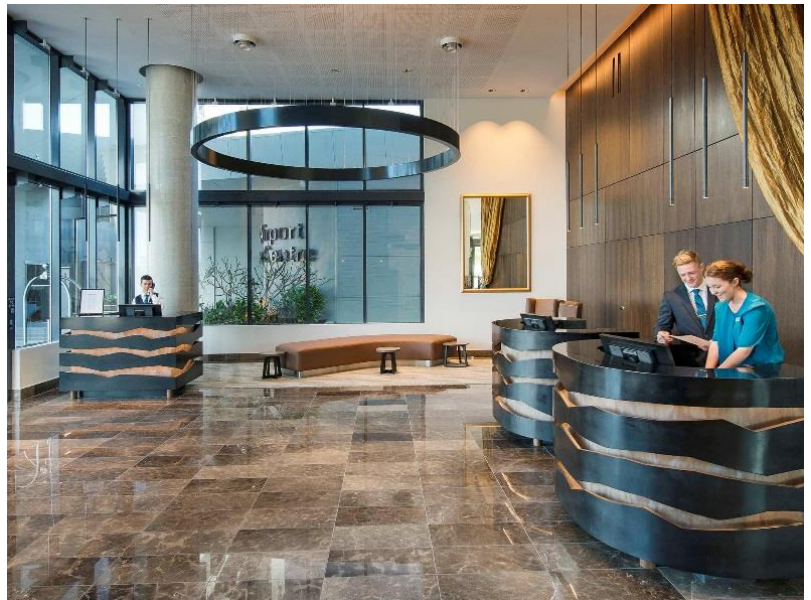

The hotel was designed by NRA Co – Lab, Brisbane, architecture & the Interior design.

TDLD worked closely with their Brisbane office to develop the initial concepts & once accepted by the client, develop those concepts into the interior design of the different spaces. The design direction from the beginning was for a modern, uncomplicated, minimalist interior, to which we responded with a lighting design that reflects this style,

W Hotel - Brisbane City

Designers: *Point of View – TDLD*

The new W Hotel in Brisbane, the hip brand from Starwood Hotel's portfolio, opened its doors in May 2018 with high expectations being the first dedicated W Hotel building in Australia.

The W brand demands style and are strongly driven by current trends within all sectors of design, including fashion, art, architecture and the like. The initial brief given by the operator isn't your standard written explanation of design requirements and light levels – it is a 5 minute video of models, dance parties, celebrities, architecture, existing properties and future aspirations of the brand. Be bold, think out of the box and design to impress.



Throughout the entire public space, the senses of the guests are always being triggered. Every turn offers a new experience, each bolder than the last. The lighting design was carefully considered in all aspects of the interiors and close collaboration with DBI and G+A's office was essential.

Waltzing Matilda Centre, Entry Foyer and Reading Room - Winton

Designer: *John Zunker - Umow Lai*

The Waltzing Matilda Centre is an important community and tourism hub and the wider region. Uplighting is used to illuminate the original Banjo Peterson statue which stands proudly in front of the Centre's main entry. This artwork was salvaged from the site following a fire that destroyed the original centre in 2015. The lighting in the foyer and reading room is inspired by the night sky by creating a random starry effect against the black ceiling. Warm 3000k downlights with a high CRI were used to enhance the natural colours of the finishes within the foyer. The warm lighting creates an intimate atmosphere in the large cavernous foyer. Coloured LED lights are used to create two features constellations; Banjo Paterson's start sign Aquarius in the foyer and the Southern Cross in the reading room.



Origin Energy Building - Helical Stairs - Brisbane City

Designer: *Anita Chow - WSP*

The helical staircase and promenade area located in Origin Energy's new premium Brisbane home at 180 Ann Street provides a new way to interaction and connection across the businesses and floors. The lighting design in this area takes Origin Energy's highest priority of health and safety into the design process whilst providing lighting creativity and originally to this space.

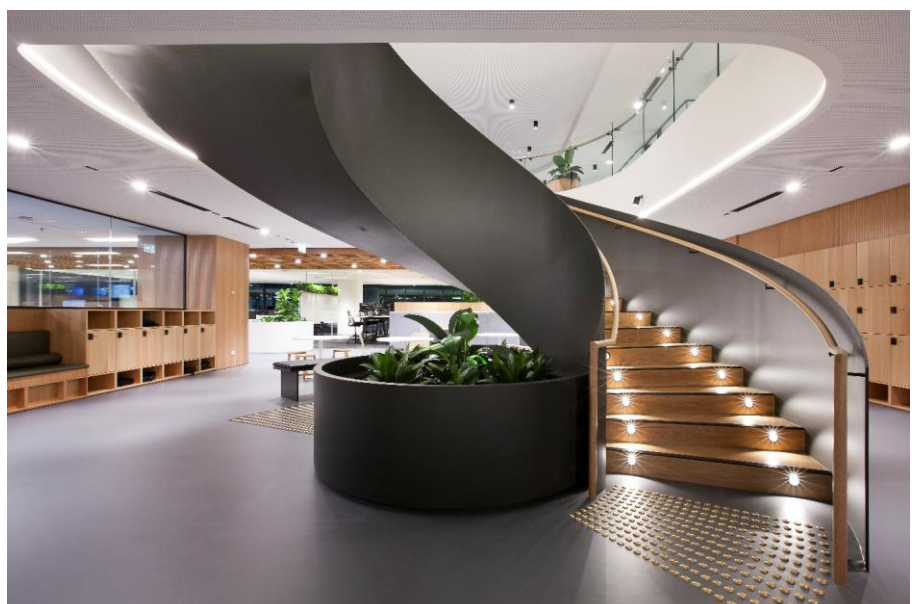

Origin Energy Building – Stoop - Brisbane City

Designer: *Anita Chow - WSP*

The town hall stoop area located in Origin Energy’s new premium home at 180 Ann Street provides a new way of interaction and connection across the businesses and floors. The lighting design in this area takes Origin Energy’s highest priority of health and safety into the design process whilst providing lighting creativity and originality to this space.



QUEENSLAND LUMINAIRE DESIGN AWARDS ENTRANTS

Detroit Bowler - ALMA Lighting

Designer: *Adam Wildman*

The Detroit Bowler is well themed to a “modern day” warehouse, and the high and exposed ceiling (service) voids commonly used these days about commercial and public building spaces. It has uniqueness of concept while keeping with old values. The fitting is robust yet very well finished and presented, to appeal to old reliable values of simplicity with quality. While the concept is not new, this luminaire is distinct in the way it is finished, and the methods used to create it.

A well finished luminaire and high-end piece of architecture. It is simple to install, efficient (per its LED light source) and very readily maintained.

It makes great use of metal surface treatments and techniques to create feature options.



ORB Pendant- TDL & ALMA Lighting

Designers: *Paula Rapach & Ash Dowthwaite (TDL), Adam Wildman & Bob Williams (ALAM)*

The ORB Pendant exudes class and intrigue. It is complex in its design and problem solving yet presents as relatively simple while using basic colour matching, straight line and crisp reflection concepts. The ease and speed in being able to repair and maintain this luminaire would no doubt have pleased the client. The design brief has been well executed. This is a robust, well finished, high end, high quality luminaire that itself could be replicated or remodelled to suit a similar application.

The fact that luminaire is home grown, yet again shows the market strength of our creative lighting “art” and industry



NEW MEMBERS ANNOUNCEMENT

The Queensland Chapter Management Committee (CMC) wish to welcome the following members:

Associate Member

Frederick Andrews

SMEC

EDUCATION

This year, the IESANZ has successfully rolled out their 2-day Introduction to Light Course in Sydney, Brisbane, Melbourne, South Australia, Western Australia and New Zealand.

Feedback from this course has been positive from the participants and their employers. We would encourage if you know of anyone who is new to the Lighting Industry or if you have new staff, to register their interest to attend future courses commencing from February 2019.

This course is also available for In-house delivery for groups in larger companies, minimum numbers apply.

Any enquiries regarding Education, please contact the Education Coordinator, Susan Wall on 0417 057 177 , susan.wall@iesanz.org

ILLUMINATING
ENGINEERING
SOCIETY

2018

**2018 QUEENSLAND AWARDS,
PRESENTATION AND ANNUAL DINNER**

FRIDAY 23RD NOVEMBER

CLOUDLAND - RAINBOW ROOM

ADDRESS: 641 ANN STREET,
FORTITUDE VALLEY QLD 4006

DR KARL KRUSZELNICKI



DOORS OPEN: 6:30pm
DINNER STARTS: 7:00pm
DRESS: FORMAL ATTIRE



WWW.IESANZ.ORG

ILLUMINATING ENGINEERING SOCIETY
2018 QUEENSLAND AWARDS,
PRESENTATION AND
ANNUAL DINNER.

FRIDAY 23RD NOVEMBER

PLATINUM SPONSORS



GOLD SPONSORS



WWW.IESANZ.ORG

NEW

Touch the Flicker

GL SPECTIS 1.0 T Flicker

Integrates the measurement of flicker parameters, colorimetric and photometric data – all in a high performance hand-held package



WHAT IS FLICKER?

- Flicker is the perception of temporal changes in the light output (luminance flicker) or color (chromatic flicker) of the light.
- Part of a broader problem termed Temporal Light Artifacts (TLA) that include:
 - Stroboscopic Effect that appears when an object with continuous motion is illuminated with a flickering light source
 - Phantom array occurs when we make a saccade (fast eye movements) and the image of the fluctuating light source is transited across the retina

WHY MEASURE FLICKER?

- Flicker frequencies from a few Hz to 70-100 Hz can be perceived by humans.
- Long exposure to light flicker causes headaches, migraines, increases eye strain and attention distraction.
- Flicker impacts workplace comfort and effectiveness while reducing visual task performance and productivity.

WHAT IS MEASURED?

- IESNA has defined two primary quantities used to characterize flicker:
 - flicker index
 - flicker percentage
- Fundamental flicker frequency is also commonly captured.



GL Optic products are made in Europe, sold and serviced in Australia by Light Metrics.

BENEFIT TO MEMBERS (INSURANCE)



Resilium Business Insurance Public Liability & Professional Indemnity Cover

Public & Products Liability Insurance

No matter what size your business is in Australia, Public and Products Liability claims can run into millions. Resilium Public Liability Insurance protects you, up to a stated limit (selected by you), if a third party sues you for personal injury, including death, or damage to property or advertising injury, as a result of an occurrence in connection with your business and you are legally liable to pay them compensation, anywhere in Australia. Why run the risk?

- ✓ Australia wide public and products liability cover from \$5m - \$20m
- ✓ Cover includes expenses for rendering first aid to others
- ✓ Cover includes legal costs and expenses
- ✓ Cover for third party property in your care, custody or control
- ✓ Products Liability cover is available
- ✓ Fast and easy claims lodgement process
- ✓ You can pay monthly to assist with your cash flow

Professional Indemnity Insurance

Professional Indemnity Insurance covers you for claims arising from allegations that your specialist services or advice caused financial loss to your customers/clients.

- ✓ Legal consultation of up 2 hours
- ✓ Court attendance costs
- ✓ Extended reporting period
- ✓ Cover for contractors
- ✓ Fast and easy claims lodgement process
- ✓ You can pay monthly to assist with your cash flow

For more information regarding the covers available please contact Luke Patrick from Reliable Insurance Solutions on 0477 346 211 or luke@reliableinsurance.com.au

Reliable Insurance Solutions Pty Ltd is an Authorised Representative of Resilium Pty Ltd ABN 40 098 080 810 AFSL No. 1246298

CURRENT CORPORATE MEMBERS

[Click on logo to visit company's website](#)

<p>DMA Engineers</p> 	<p>Eagle Lighting</p> 
<p>Gerard Lighting</p> 	<p>GM Poles</p> 
<p>JSB</p> 	<p>Klik Systems</p> 
<p>Light and Design Group</p> 	<p>LSI Hamilton Lighting Systems</p> 
<p>Lumen8</p> 	<p>Orca Solar</p> 
<p>Orion Solar</p> 	<p>PROJECT 20</p> 
<p>Versalux</p> 	

The Illuminating Engineering Society
Queensland Chapter
Level 2,70 Merivale Street
P.O. Box 3275
SOUTH BRISBANE QLD 4101
Phone:02 9431 8663
Email: qldsecretary@iesanz.org
Website: www.iesanz.org